COMMUNICATIONS

Post Office Class: First
Newspapers **Frequency**
The Crockett Times Weekly
Radio Stations: One local
Television Stations: 1 in Jackson; 5 in Memphis
Cable Television: Charter Communications
Telephone Company: Crockett Telephone Company

FINANCE

Banks: 3
No. of Branches: 5
Combined Deposits: \$96,061,000
Date of Deposit: June 30, 2017

GOVERNMENT

Gov't (type): City: Mayor & Board of Aldermen
County: County Mayor & Commission

	City	County
Police Officers:	6	12
Police Cars:	3	8
Planning Commission:	Yes	Yes
Zoning Regulations:	Yes	Yes
Industrial Development Board:	Yes	Yes
Firefighters:	5	1
Volunteers:	23	
Insurance Rating:	6	9

CLIMATE

Annual Average Temperature: 62.1°
Monthly Average High Temp. Jan. 48.1° July 91.2°
Monthly Average Low Temp. Jan. 29.1° July 69.3°
Annual Average Precipitation: 49.73"
Annual Average Snowfall: 4.8"
Elevation: 450' above sea level
Prevailing Winds: South-Southwest
Mean Length of Freeze Free Period (Days): 236

NATURAL RESOURCES/AG PRODUCTS

Minerals: Sand
Timber: Oak & Gum
Crops: Cotton, Corn, Soybeans & Wheat

COMMUNITY FACILITIES

Licensed Day Care Providers

Day Care Centers: 4
Day Care Homes: 0

Education

State Industrial Training Service Available: Yes

Type of Public School System: County

	Schools	Enrollment
Elementary	5	1,382
Middle/Jr. High.....	1	574
Senior High	1	842
Private &/or		
Parochial	0	
Technology Centers...	2*	
Colleges.....	0	
Libraries	1	Collection 219,512 w/READS:

*within 20 miles

Health Care

Hospitals: 2* (787 Beds)
Clinics: 3
Doctors: 3
Dentists: 5
Nursing Homes: 1 (121 Beds)
*Jackson - 22 miles

Churches

Protestant: 24
Catholic: 0
Jewish: 0
Other: 0

Recreation

Parks	2	
Golf Courses.....	1	
Swimming Pools...	1	
Country Clubs.....	1	
Theaters.....	0	
Bowling Alleys.....	0	
Hotels & Motels ...	0	# Rooms: 0
Largest Meeting Room Capacity	0	
Restaurants	8	

**SELECTED ECONOMIC INDICATORS
FOR CROCKETT COUNTY**

Estimated County Available Labor

Date: 01/18
Total: 310
In Surrounding Labor Market Area: 5,100
High School Graduates 2017: 199

Labor Force Estimates

Annual Average Employment	2016
Civilian Labor Force.....	6,790
Unemployment	420
% of Labor Force.....	6.1%
Total Employment.....	6,370

Per Capita Income

Year	Amount
2016	\$35,543

Retail Sales

Year	Amount
2016	\$111,258,796

Educational Attainment (25 years & older)

	Percentage
Under 12 Years	23.5
12 – 15 Years	62.9
12 Years only	39.5
Some College	18.4
Associate Degree	5.0
High School Degree or Higher	76.5
16 Years or more	4.9
16 Years only	8.7
Bachelor’s Degree or Higher	13.6

Ten Year Manufacturing Growth Report

Years: 2008-2017	New Plants	Expansions
Number Projects:	2	2
Total Investments:		

UTILITIES

Electricity

Electric Power System: Gibson Electric Membership Corporation
Source Company: TVA

Gas

Gas Supplier: Crockett Public Utilities
Source Company: Williams Pipeline
Fuel Oil Suppliers: 2
Suppliers of LP Gas: 1

Water

Source: 4 wells - City of Alamo
Capacity: 1,728,000 GPD
Current Consumption: 350,000 GPD
Storage Capacity: 500,000 GPD

Sewer

Type of Treatment: Oxidation Ditch – City of Alamo
Capacity: 400,000 GPD
Current Usage: 240,000 GPD
% City Sewer Coverage 100
% Storm Sewer Coverage 25
Solid Waste Disposal: County landfill

AVAILABLE INDUSTRIAL PROPERTIES

Visit www.wtia.org for the latest listing of industrial buildings and acreage for sale and/or lease.

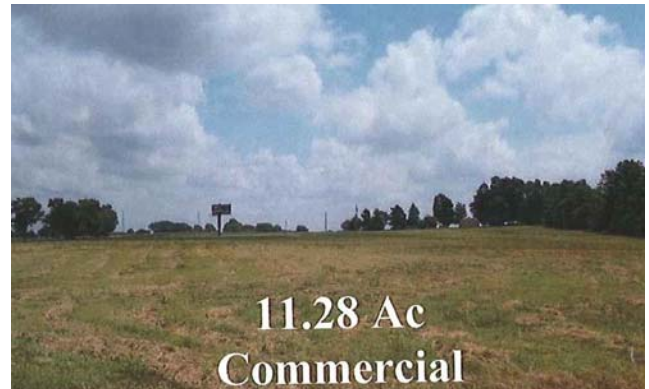

**11.28 Ac
Commercial**

*Hickman Property
11.28 acres*

LOCAL INDUSTRY

Firm Name	Product	Employment Total
Asea Brown Boveri	Transformers and components	125
Crockett County Nursing Home	Nursing Home	121
Med Line Industries	Medical supplies	50
Southern Pride Distributing	BBQ pits and grills/smokers	36
Alamo Pride	Textile products	30
Mid-South Farmers Co-Op	Blending of fertilizers	17
Helena Chemical	Distribution of blended fertilizers	15
West Tennessee Pallet & Crate	Pallets and skids	6
Hughes Trailers Manufacturing & Sales	Utility trailers	5
Crockett Times	Newspaper	4
Partners Pallet	Skids	3

For Further Information Contact:

West Tennessee Industrial Association
26 Conrad Drive
Jackson, TN 38305
800-336-2036
www.wtia.org
westtn@wtia.org

Crockett County Chamber of Commerce
29 North Bells Street
Alamo, TN 38001
Phone: (731) 696-5120
www.crockettchamber.com
cmoore@crockettchamber.com